



ANA-QUICK[®]

Nylon Flexible Conduit



***Canada's leader of Flexible Conduit Systems
brings you the next generation of
flexible conduits!***

Use the best...

Use ANAMET!

Anamet Canada Inc.
PO Box 550
Colborne, Ontario K0K 1S0

Phone: (905) 355-2122
Fax: (905) 355-3110
www.anametcanada.com
E-mail: csr@anametcanada.com



Anamet Canada's New ANA-QUICK Conduit System

Table of Contents:

Page #	Product
3	ANA-QUICK System Overview
4	Conduit Selection Guide
5	Fitting Specifications
6	Conduit & Accessories Part Number Scheme
7	Fitting Part Number Scheme
8-9	AC6L, AC6S and AC12S Conduit
10	NPT Fittings
11	PG Fittings and Flanges
12	Saddles
13	Conduit T and Y Accessories
14	IP67 Seals for Fittings
15	PG Lock Nuts and Quick-Key

ANA-QUICK Quick-Key locking system

ANA-QUICK: The quick method of installing flexible corrugated liquid tight conduit. Made from Nylon PA6 or PA12 for excellent performance in flexible OEM applications.

The specially made ANA-QUICK[®] connector holds securely, not allowing inadvertent pull-outs like alternative systems. Removal of connector is achieved by use of a Quick-Key safety opener.



Anamet Canada's New ANA-QUICK Conduit System



Anamet's new solution for high flexing OEM applications.



PA6 & PA12 Conduit

Features:

- Quick installation, easy connection without tools
- Labour savings
- Quick-Key safety lock system holds connection securely until removed by special opener
- Made from polyamide PA6 Nylon, halogen free
- Temp. range: -40°C to +120°C
- IP 68 conduit and IP65 rated fittings, resistant to alcohol, greases, fuels, mineral spirits. IP67 & IP68 fittings available with optional seals.

Applications:

- Passenger Rail vehicle
- Fiber optics
- Machine tools
- Medical equipment
- Robotics
- Harnesses



Connector Systems

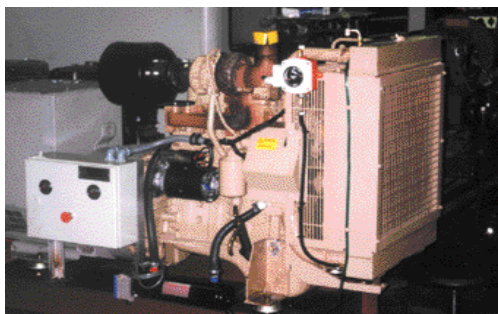

OEM machine/equipment builders: Tight bend radius, and high flexing applications for cat-track and robotics.

Applications include:

Transportation applications: light weight, plus easy installation and tight bend radius.



ANA-QUICK Conduit Selection Guide

Type:	Material	Wall	Size Range	Flexibility	Temperature	IP Rating	Crush	UL Rec.
AC6L	PA6 Nylon	Thin	12 - 29	Very Good	-40°C--+120°C	IP68	Good	-
AC6S	PA6 Nylon	Standard	7.5 - 48	Good	-40°C--+120°C	IP68	Very Good	
AC12S	PA12 Nylon	Standard	12 - 48	Excellent	-40°C--+100°C	IP68	Very Good	-

ANA-QUICK Conduit System is CE approved and based on the EN 50086 Classifications. The table below summarizes the classification of the 3 types of **ANA-QUICK Conduit**.

CE EN 50086 Classification Table:	ANA-QUICK	AC6L	AC6S 	AC12S
	Compression resistance	Very Light (125N)	Light (320N)	Light (320N)
	Impact Resistance	Very Light (0.5J)	Light (1J)	Light (1J)
	Min. Temperature	-40° C	-40° C	-40° C
	Max. Temperature	+120° C	+120° C	+100° C
	Bending Resistance	Flexible	Flexible	Flexible
	IP Rating	IP 68	IP 68	IP 68
	Corrosion Resistance	High	High	High
	Tensile Strength	Very Light (100N)	Light (250N)	Light (250N)
	Flame Resistance	Self Extinguishing	Self Extinguishing	Self Extinguishing

The **ANA-QUICK SYSTEM** is based on the European standard of conduit sizes, which is referred to as NW sizes. The chart shown here gives you a quick reference from the European NW standard to the Trade Sizes that we use in Canada.



Trade Size	ID Range	Equivalent ANA-QUICK NW Size	
1/4"	.245-.260"	NW 7.5	.264"
5/16"	.390-.405"	NW 10	.390"
3/8"	.484-.504"	NW 12	.480"
1/2"	.622-.642"	NW 17	.654"
3/4"	.820-.840"	NW 23	.913"
1"	1.041-1.066"	NW 29	1.142"
1-1/4"	1.380-1.410"	NW 36	1.417"
1-1/2"	1.575-1.600"	NW 36	1.417"
2"	2.020-2.045"	NW 48	1.878"

ANA-QUICK Fittings (page 10-11) Specifications:

Standard **ANA-QUICK Fittings** are made from PA6 Nylon and are rated IP65. These fittings are designed to fit all ANA-QUICK conduit types and can be disassembled from the conduit after they have been assembled by using the Quick-Key safety opener.



SPECIFICATIONS:

Construction:

Modified Polyamide (PA6V0),
Halogen Free.

Flame Properties:

Self Extinguishing

Resistant:

Alcohol, greases, fuels, mineral
spirits, weak bases and weak
acids.

IP Rating:

IP 65 (IP67 & IP68 options)

Temperature Range:

-40°C to +110°C

Colour: Black

Approval:

UL Recognized E148858

APPLICATIONS:

- All ANA-QUICK conduit types.
- Vibration areas
- Wash down areas (when assembled with OD seal.)

ANA-QUICK Fitting Assembly / Disassembly Guide:

ANA-QUICK fittings are easily assembled by just pushing the conduit into the fitting. The unique locking mechanism firmly holds the conduit in place, without the possibility of inadvertent removal.

In order to disassemble the conduit, a Quick-Key is required. This allows control of the possible tampering of the conduit by controlling access to the Quick-Keys.





CONDUIT:

AC__-... (P 8-9)

AC6L-17B

Colour:
B Black

Profile (AC Series):

- 6L Nylon 6 Thin Wall
- 6S Nylon 6 Standard Wall
- 12S Nylon 12 Standard Wall

NW Trade Size (ID):

- 07 7.5 mm
- 10 10 mm
- 12 12 mm
- 17 17 mm
- 23 23 mm
- 29 29 mm
- 36 36 mm
- 48 48 mm

Accessories:

AR__-... (P 12-13)

ARNS-07B

Colour:
B Black

Accessories (AR series):

- NY Nylon 'Y' Connector
- NT Nylon 'T' Connector
- NS Nylon Saddle
- NC Nylon Saddle Cover

NW Trade Size (ID):

- 07 7.5 mm
- 10 10 mm
- 12 12 mm
- 17 17 mm
- 23 23 mm
- 29 29 mm
- 36 36 mm
- 48 48 mm

AFN0-17N050B

FITTINGS:
AF__-... (P 10-11)

Material:

N Nylon

QK Quick-Key p15

OS OD Seal p14

Colour:

B Black

Profile (AC Series):

0 Straight Fitting

4 45° Fitting

9 90° Fitting

F 90° Flange

NW Trade Size (ID):

07 7.5 mm

10 10 mm

12 12 mm

17 17 mm

23 23 mm

29 29 mm

36 36 mm

48 48 mm

Thread Size:

NPT:

050 1/2"

075 3/4"

100 1"

125 1-1/4"

150 1-1/2"

200 2"

PG:

07 PG07

09 PG09

11 PG11

13 PG13.5

21 PG21

29 PG29

36 PG36

48 PG48

Fitting Thread:

N NPT

P PG

Lock nuts are NOT included with fittings.
PG lock nuts also available, but not shown on this part number scheme.

Please note: Refer to specific product page for details and specifications. Not all part numbers that can be created by this part number scheme are currently available from Anamet Canada. Part numbers specifically shown in this catalog are currently available.



Type AC6_ - ____ : PA6 Conduits - Extra Flexible



Type AC6L and AC6S conduits are corrugated polyamide conduits specially designed for machine tool applications that require protection for cables. Type AC6L is a thin wall tubing which is very flexible and has a tight bend radius. Type AC6S is a standard wall conduit, which is UL Recognized.

Conduit: Type AC6L - Thin Wall

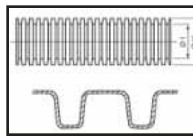

Size NW	Item ID	Inside Diameter	Outside Diameter	Bend Radius		Std. Pkg. Meters
				Static	Dynamic	
12	AC6L-12B	12.5 (0.492)	15.7 (0.618)	26 (1.024)	78 (3.071)	50
17	AC6L-17B	17.0 (0.669)	21.2 (0.835)	40 (1.575)	120 (4.724)	50
23	AC6L-23B	23.5 (0.925)	28.4 (1.118)	50 (1.969)	150 (5.906)	50
29	AC6L-29B	29.4 (1.157)	34.5 (1.358)	58 (2.283)	174 (6.850)	25

Dimensions in mm (inches)

Conduit: Type AC6S - Standard Wall

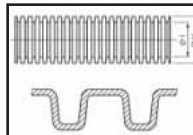

Size NW	Item ID	Inside Diameter	Outside Diameter	Bend Radius		Std. Pkg. Meters
				Static	Dynamic	
7.5	AC6S-07B	6.7 (0.264)	10.0 (0.394)	13 (0.512)	39 (1.535)	50
10	AC6S-10B	9.9 (0.390)	13.0 (0.512)	20 (0.787)	60 (2.362)	50
12	AC6S-12B	12.2 (0.480)	15.7 (0.618)	30 (1.181)	90 (3.543)	50
17	AC6S-17B	16.6 (0.654)	21.2 (0.835)	45 (1.772)	135 (5.315)	50
23	AC6S-23B	23.2 (0.913)	28.3 (1.114)	55 (2.165)	165 (6.496)	50
29	AC6S-29B	29.0 (1.142)	34.5 (1.358)	65 (2.559)	195 (7.677)	25
36	AC6S-36B	36.0 (1.417)	42.4 (1.669)	90 (3.543)	270 (10.630)	25
48	AC6S-48B	47.7 (1.878)	54.0 (2.126)	100 (3.937)	300 (11.811)	25

Dimensions in mm (inches)



ANA-QUICK Type AC6S is UL Recognized. This allows usage in machine building where this is required.

SPECIFICATIONS:

Construction:

Corrugated conduit from Modified Polyamide (PA6), Halogen Free.

Flame Properties:

AC6L: Self Extinguishing

AC6S: Class HB, UL-94, flame retarding

Resistant:

Alcohol, greases, fuels, mineral spirits, weak bases and weak acids.

Temperature Range:

-40°C to +120°C (intermittent to 150°C)

Colour: Black

Approval:

AC6S - UL Recognized

APPLICATIONS:

- Machine building, switch cabinets, movable machinery
- Rail vehicles, commercial vehicles, construction machinery
- AC6S: For high mechanical strength

Fittings for these conduits found on Page 10-11



Type AC12S-____ : PA 12 Conduits - Extreme Flexible



Type AC12 conduit is a corrugated polyamide conduit made from PA12 Nylon for superior flexing qualities. The standard wall conduit has good mechanical strength while still having a tight bend radius and being able to withstand continuous flex applications.

Conduit: Type AC12S - Standard Wall

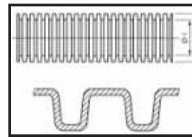

Size NW	Item ID	Inside Diameter	Outside Diameter	Bend Radius		Std. Pkg. Meters
				Static	Dynamic	
12	AC12S-12B	12.2 (0.480)	15.7 (0.618)	22 (0.866)	66 (2.598)	50
17	AC12S-17B	16.6 (0.654)	21.2 (0.835)	27 (1.063)	81 (3.189)	50
23	AC12S-23B	23.2 (0.913)	28.3 (1.114)	45 (1.772)	135 (5.315)	50
29	AC12S-29B	29.0 (1.142)	34.5 (1.358)	50 (1.969)	150 (5.906)	25
36	AC12S-36B	36.0 (1.417)	42.4 (1.669)	80 (3.150)	240 (9.449)	25
48	AC12S-48B	47.7 (1.878)	54.0 (2.126)	100 (3.937)	300 (11.811)	25

Dimensions in mm (inches)

SPECIFICATIONS:

Construction:

Corrugated conduit from Modified Polyamide (PA12), Halogen Free.

Flame Properties:

Class HB, UL-94, flame retarding

Resistant:

Alcohol, greases, fuels, mineral spirits, weak bases and weak acids.

Temperature Range:

-40°C to +100°C (intermittent to 130°C)

Colour: Black

APPLICATIONS:

- Machine building
- Robotics
- Applications requiring continuous flexing



Application Notes:

When installing any ANA-QUICK Conduits, please be sure to conform to the bend radius specified. Both Static and Dynamic bend radii are indicated for conduits:

Static:

Application does not move after installed.

Dynamic:

Application will flex once installed, as in robotic or cat track applications.

Fittings for these conduits found on Page 10-11



Type AFN - __ N __ B: Fittings with NPT Threads

NPT Thread Straight Fittings

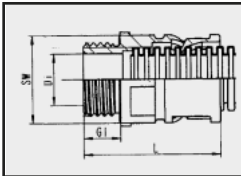

Size	Item	Thread	Dimensions mm (inches)			Std. Pkg.
			GL	SW	L	
NW 12	AFN0-12N 050B	1/2" (16)	8 (.315)	21 (.827)	31 (1.220)	25
NW 17	AFN0-17N 050B	1/2" (16)	10 (.394)	27 (1.063)	36 (1.417)	25
NW 23	AFN0-23N 075B	3/4" (21)	12 (.472)	36 (1.417)	41 (1.614)	10
NW 29	AFN0-29N 100B	1" (27)	12 (.472)	40 (1.575)	43 (1.693)	10
NW 36	AFN0-36N 125B	1-1/4" (35)	15 (.591)	50 (1.969)	54 (2.126)	10
NW 48	AFN0-48N 150B	1-1/2" (41)	15 (.591)	65 (2.559)	58 (2.283)	10
NW 48	AFN0-48N 200B	2" (53)	15 (.591)	65 (2.559)	58 (2.283)	10

NPT Thread 45° Fittings

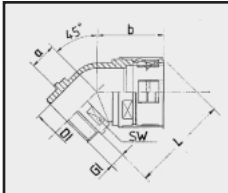

Size	Item	Thread	Dimensions mm (inches)			Std. Pkg.
			GL	SW	L	
NW 23	AFN4-23N 075B	3/4" (21)	12 (.427)	36 (1.417)	64 (2.520)	10
NW 29	AFN4-29N 100B	1" (27)	12 (.427)	40 (1.575)	75 (2.953)	10

NPT Thread 90° Fittings

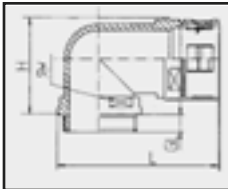

Size	Item	Thread	Dimensions mm (inches)				Std. Pkg.
			GL	SW	L	H	
NW 12	AFN9-12N 050B	1/2" (16)	8 (.315)	21 (.827)	50 (1.969)	30 (1.181)	25
NW 17	AFN9-17N 050B	1/2" (16)	10 (.394)	27 (1.063)	59 (2.323)	35 (1.378)	25
NW 23	AFN9-23N 075B	3/4" (21)	12 (.472)	36 (1.417)	78 (3.071)	44 (1.732)	10
NW 29	AFN9-29N 100B	1" (27)	12 (.472)	40 (1.575)	88 (3.465)	52 (2.047)	10
NW 36	AFN9-36N 125B	1-1/4" (35)	16 (.630)	50 (1.969)	103 (4.055)	67 (2.638)	10
NW 48	AFN9-48N 150B	1-1/2" (41)	16 (.630)	65 (2.559)	126 (4.961)	82 (3.228)	10
NW 48	AFN9-48N 200B	2" (53)	16 (.430)	65 (2.559)	126 (4.961)	82 (3.228)	10

Lock nuts are NOT included with fittings.
Fitting Specifications on Page 5.

ANA-QUICK Fittings



Type AFN_ - __P__B: Fittings with PG Threads and Flange Fittings

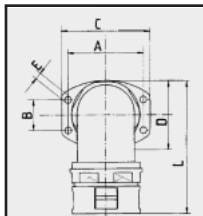
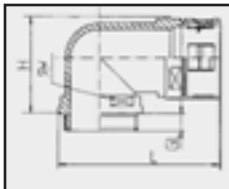
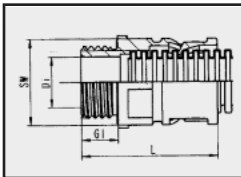

PG Thread Straight Fittings



Size	Item	Thread	Dimensions mm (inches)			Std. Pkg.
			GL	SW	L	
NW	ID	Size				
7.5	AFN0-07P07B	PG 7	7 (.276)	14 (.551)	24 (.945)	25
10	AFN0-10P09B	PG 9	8 (.315)	19 (.748)	28 (1.102)	25
12	AFN0-12P11B	PG 11	8 (.315)	21 (.827)	31 (1.220)	25
17	AFN0-17P13B	PG 13.5	10 (.394)	27 (1.063)	36 (1.417)	25
23	AFN0-23P21B	PG 21	12 (.472)	36 (1.417)	41 (1.614)	10
29	AFN0-29P29B	PG 29	12 (.472)	40 (1.575)	43 (1.693)	10
36	AFN0-36P36B	PG 36	15 (.591)	50 (1.969)	54 (2.126)	10
48	AFN0-48P48B	PG 48	15 (.591)	65 (2.559)	58 (2.283)	10

PG Thread 90° Fittings



Size	Item	Thread	Dimensions mm (inches)				Std. Pkg.
			GL	SW	L	H	
NW	ID	Size					
12	AFN9-12P11B	PG 11	8 (.315)	21 (.827)	50 (1.969)	30 (1.181)	25
17	AFN9-17P13B	PG 13.5	10 (.394)	27 (1.063)	59 (2.323)	35 (1.378)	25
23	AFN9-23P21B	PG 21	12 (.472)	36 (1.417)	78 (3.071)	44 (1.732)	10

90° Flange Fittings



Size	Item	Bore Size	Dimensions mm (inches)			Std. Pkg.
			A / B	C	E	
NW	ID	Size				
17	AFNF-17B	16.4	36 (1.417)	46 (1.811)	5.5 (.217)	10
23	AFNF-23B	22.8	53 (2.087)	63 (2.480)	6.5 (.256)	10
29	AFNF-29B	27.0	54 (2.216) / 36 (1.417)	67 (2.638)	6.5 (.256)	10
36	AFNF-36B	38.3	73 (2.874) / 30 (1.181)	86 (3.387)	6.5 (.256)	10
48	AFNF-48B	47.7	73 (2.874) / 30 (1.181)	86 (3.386)	6.5 (.256)	5

Lock nuts are NOT included with fittings.
PG lock nuts are available (see Page 15).



Type ARN_:
Accessories for ANA-QUICK System

Saddles for ANA-QUICK Conduit

ANA-QUICK Saddles can be used to fasten the conduit to your equipment. The unique design of these saddles allow s them to be connected to each other side by side, or stacked on top of each other. This allow s easy combination of conduits in any configuration. Common sized tabs on the side of each saddle make it easy to combine different sizes of conduits side by side. Same size conduits can be stacked on each other (w ithout the cover between saddles) to increase wiring density in the application.

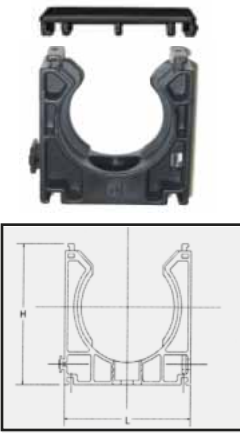
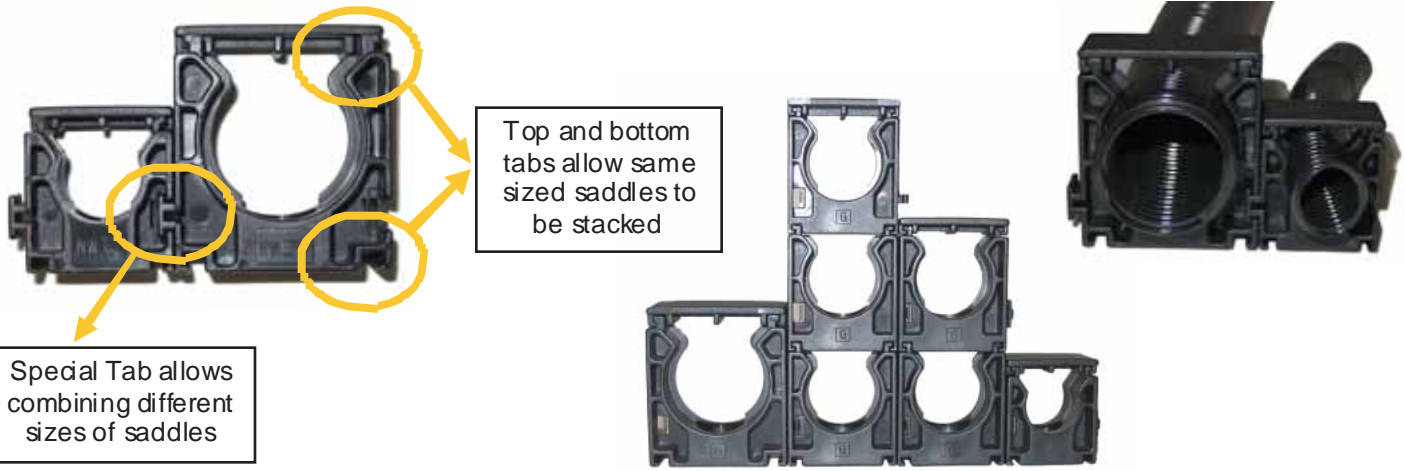

Size	Saddle Item ID	Cover Item ID	Dimensions mm (inches)			Std.
			H - without cover	H - with cover	L	Pkg.
7.5	ARNS-07B	ARNC-07B	28.0 (1.102)	29.5 (1.161)	26.0 (1.024)	25
10	ARNS-10B	ARNC-10B	28.0 (1.102)	29.5 (1.161)	26.0 (1.024)	25
12	ARNS-12B	ARNC-12B	28.0 (1.102)	30.0 (1.181)	26.0 (1.024)	25
17	ARNS-17B	ARNC-17B	34.5 (1.358)	36.5 (1.437)	30.0 (1.181)	25
23	ARNS-23B	ARNC-23B	42.5 (1.673)	44.5 (1.752)	38.0 (1.496)	10
29	ARNS-29B	ARNC-29B	48.0 (1.890)	50.0 (1.969)	46.5 (1.831)	10
36	ARNS-36B	ARNC-36B	58.0 (2.283)	60.0 (2.362)	57.5 (2.264)	10
48	ARNS-48B	ARNC-48B	70.0 (2.756)	72.0 (2.835)	68.5 (2.697)	10



Type ARN_ Accessories for ANA-QUICK System

'T' and 'Y' Connectors for ANA-QUICK Conduit

ANA-QUICK 'T' and 'Y' Connectors can be used to split the conduit for connection of multiple points. These connections are shipped split, for easy assembly to the conduit. They come in various combinations to join different sizes of conduits.



'T' Connector

Item	For Conduit Size			Std. Pkg.
	A	B	C	
ARNT-121010	NW 12	NW 10	NW 10	1
ARNT-121012	NW 12	NW 10	NW 12	1
ARNT-121210	NW 12	NW 12	NW 10	1
ARNT-121212	NW 12	NW 12	NW 12	1
ARNT-171212	NW 17	NW 12	NW 12	1
ARNT-171217	NW 17	NW 12	NW 17	1
ARNT-232323	NW 23	NW 23	NW 23	1

'Y' Connector

Item	For Conduit Size			Std. Pkg.
	A	B	C	
ARNY-121010	NW 12	NW 10	NW 10	1
ARNY-121210	NW 12	NW 12	NW 10	1
ARNY-121212	NW 12	NW 12	NW 12	1
ARNY-171217	NW 17	NW 12	NW 17	1
ARNY-231717	NW 23	NW 17	NW 17	1
ARNY-232323	NW 23	NW 23	NW 23	1



**Type AF_S:
Seals for IP68 Rating**

Seals for ANA-QUICK Fittings

For applications that require a water-tight seal, you can upgrade the connector from IP65 to IP67. IP68 is available by special order. To get an IP67 rating, just add OD Seal. To further protect the connector from collecting debris, the OD seal can be added to the IP68 connector.



IP 65:	
IP 67:	
IP 68 connector (spec. order):	
IP 68 connector with AFOS seal:	

OD Seal



Size	Item	Std.
NW	ID	Pkg.
12	AFOS-12G	25
17	AFOS-17G	25
23	AFOS-23G	10
29	AFOS-29G	10
36	AFOS-36G	10
48	AFOS-48G	10



Type AT_L: PG Locknuts for ANA-QUICK Fittings

PG Lock Nuts

PA6 Nylon



Item ID	Thread Size	Std. Pkg.
ATNL-P07B	PG 7	25
ATNL-P09B	PG 9	25
ATNL-P11B	PG 11	25
ATNL-P13B	PG 13.5	25
ATNL-P21B	PG 21	10
ATNL-P29B	PG 29	10
ATNL-P36B	PG 36	10
ATNL-P48B	PG 48	10

Nickel Plated



Item ID	Thread Size	Std. Pkg.
—	-	-
—	-	-
—	-	-
ATSL-P13	PG 13.5	25
ATSL-P21	PG 21	10
ATSL-P29	PG 29	10
ATSL-P36	PG 36	10
ATSL-P48	PG 48	10



Type AFQK: ANA-QUICK Quick-Key



Size	Item ID	Std. Pkg.
7.5	AFQK-07B	5
10	AFQK-10B	5
12	AFQK-12B	5
17	AFQK-17B	5
23	AFQK-23B	5
29	AFQK-29B	5
36	AFQK-36B	5
48	AFQK-48B	5



ANAMET CANADA Complete Product Offering:

Liquidtight Conduits:

- **Conseal Metallic Flexible Conduits**
 - Type CSA Canada's standard in CSA Approved Flexible Conduit
 - Type CW Computer Blue CSA Approved
 - Type HTC High Temperature Flexible Conduit
 - Type HTX Extreme Temperature Flexible Conduit
- **Sealtite Metallic Flexible Conduits:**
 - Type EFST Extra Flexible Conduit
 - Type UA Dual Rated CSA and UL Conduit
 - Type OR Oil Resistant Conduit
 - Type EFL Aluminum Core Conduit
 - Type HTUA High Temperature, UL Approved Conduit
 - Type HCX High and Low Temperature Conduit
 - Type ZHUA Low Smoke, Zero Halogen UL approved Conduit
 - Type Shieldtite High EMI/EMP Shielded Conduit
 - Type NWC Nuclear Radiation Resistant Conduit
 - Type MTC Metallic Machine Tool Conduit
- **Sealtite Non-Metallic Conduits**
 - Type NMUA CSA / UL Conduit
 - Type NMEF Extra Flexible OEM Tubing
 - Type CNP Type A CSA/UL Orange Conduit
- **ANA-QUICK Nylon Conduits**
 - Complete conduit system for machine building applications

Non-Jacketed Conduits:

- **Aluminum - No Jacket:**
 - CSA Aluminum CSA approved flexible Conduit
 - RW Aluminum UL approved flexible Conduit
- **Galvanized Steel - No Jacket**
 - Type DSL Extra Flexible OEM Conduit
 - Type DE-710/183 Extra Flexible Heavy Duty Conduit
- **Stainless Steel**
 - Type SL Standard Duty OEM Conduit
 - Type UI Cap Heavy Duty OEM Conduit

Protective Sleeving:

- **Firetech Protective Sleeving**
 - Sleeve, Wrap Extreme temperature sleeving

Connectors:

- LT Series For Conseal and Sealtite conduits
- NMLT Series For Type NMUA and NMEF conduits
- STNM Series For Type CNP conduit

This catalogue includes only the ANA-QUICK product offering. All other products in our main Sealtite catalogue. Contact your local rep, or the factory to be sent our complete catalog.

ANAMET CANADA INC.

PO Box 550
Colborne, Ontario K0K 1S0

Telephone: (905) 355-2122

Fax: (905) 355-3110

<http://www.anametcanada.com/>

E-mail: csr@anametcanada.com