



Stainless Steel Ultra-Flex Type SL/ UI-Cap: Ultra Flexible Stainless Steel Conduit

Type SL:



Square Lock Design

Size	Item ID	Std. Pkg. Feet	Inside Diameter			Outside Diameter mm (in.)		Bend Dia. mm (in.)	Weight Kg/m (lbs/cft)
			Min	Min	Max	Min	Max		
5/32"	460613	AVAILABLE IN RANDOM LENGTHS	3.86 (0.152)	5.89 (0.232)	6.20 (0.244)	51 (2.0)	1.59 (107)		
3/16"	460616		4.65 (0.183)	6.68 (0.263)	6.98 (0.275)	51 (2.0)	1.82 (122)		
7/32"	460619		5.23 (0.206)	7.39 (0.291)	7.77 (0.306)	51 (2.0)	2.10 (141)		
1/4"	460622		6.22 (0.245)	8.38 (0.330)	8.76 (0.345)	51 (2.0)	2.50 (168)		
9/32"	460626		7.27 (0.286)	9.17 (0.361)	9.55 (0.376)	63 (2.5)	2.72 (183)		
5/16"	460628		7.67 (0.302)	10.46 (0.412)	10.85 (0.427)	63 (2.5)	2.95 (198)		
3/8"	460634		9.22 (0.363)	12.01 (0.473)	12.52 (0.493)	76 (3.0)	3.41 (229)		
1/2"	460643		12.27 (0.483)	15.32 (0.603)	15.82 (0.623)	83 (3.3)	4.54 (305)		

All dimensions in mm (inches)

Type UI-CAP:



Interlocked Design

Actual ID Size	Item ID	Std. Pkg. Feet	Inside Diameter			Outside Diameter mm (in.)		Bend Dia. mm (in.)	Weight Kg/m (lbs/cft)
			Min	Min	Max	Min	Max		
5/32"	451550	AVAILABLE IN RANDOM LENGTHS	4.06 (0.160)	6.48 (0.255)	6.86 (0.270)	63 (3.0)	3.00 (202)		
3/16"	451554		4.57 (0.180)	6.98 (0.275)	7.37 (0.290)	63 (3.0)	3.63 (244)		
1/4"	451564		6.22 (0.245)	8.64 (0.340)	9.02 (0.355)	63 (3.0)	4.54 (305)		
5/16"	451568		7.87 (0.310)	10.29 (0.405)	10.21 (0.420)	63 (3.0)	5.68 (382)		
3/8"	451572		9.40 (0.370)	12.32 (0.485)	12.83 (0.505)	63 (3.0)	6.58 (442)		
7/16"	451574		10.97 (0.432)	13.89 (0.547)	14.40 (0.567)	126 (5.0)	7.72 (519)		
1/2"	451576		12.57 (0.495)	15.49 (0.610)	16.00 (0.630)	126 (5.0)	7.26 (488)		

All dimensions in mm (inches)

Type SL and Type UI-CAP:

RoHS

- Flexible Stainless Steel conduit
- Designed for OEM applications where corrosion is an issue and no approvals are required.
- Type SL: Square-locked profile.
- Type UI-Cap: Fully-interlocked profile
- Available in custom cut lengths.

For connectors for this conduit, see page 33
For cutting instructions, see page 37

SPECIFICATIONS:

- Type 302 Stainless Steel square-lock (SL) or fully-interlocked (UI-CAP).
- Temperature range: +450°C (+842°F) Max.

APPLICATIONS:

- Applications where corrosion is an issue and where no approvals are required
- Sensor cable protection
- OEM Probe cables

SS ULTRA-FLEX Series

ANAMET



Stainless Steel Flex Connectors: For use with Type SL/UI-Cap



Straight:



SL/UI	Item	Dimensions			KO Size	Weight	Standard
Size	ID	A	B	C	NPT	Kg(lb)/Pkg	Package
3/8"	SSUI38	37.00 (1.457)	13.00 (0.512)	26.00 (1.024)	1/2"	1.6 (3.5)	25
1/2"	SSUI50	37.00 (1.457)	13.00 (0.512)	29.00 (1.142)	1/2"	2.0 (4.4)	25

All dimensions in mm (inches)

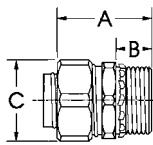

90 Degree:



SL/UI	Item	Dimensions				KO Size	Weight	Standard
Size	ID	A	B	C	D	NPT	Kg(lb)/Pkg	Package
3/8"	SSUI9038	36.00 (1.417)	13.00 (0.512)	26.00 (1.024)	43.00 (1.693)	1/2"	1.0 (2.2)	10
1/2"	SSUI9050	36.00 (1.417)	13.00 (0.512)	29.00 (1.142)	43.00 (1.693)	1/2"	1.3 (2.9)	10

All dimensions in mm (inches)

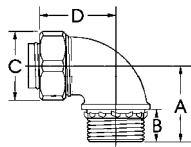

Special ferrule allows fitting to accept Ultra Flexible Type SL sizes 3/8" and 1/2". Positive ferrule connection for interconnect to standard NPT applications.

SPECIFICATIONS:

- 303 Stainless Steel (internal ferrule: Nickel-plated Brass)
- Colour: Silver
- Temp. range: -45°C to +105°C (-49°F to +221°F)

SSUI Series Stainless Steel Connectors:

- Special ferrule allows connection to either Type SL conduit
- Excellent for harsh installation
- Excellent protection for small diameter cables or fiber-optics
- Corrosion resistant

Phone: (613) 398-1313
 Fax: (613) 398-6262
 www.anametcanada.com
 E-mail: csr@anametcanada.com

Anamet Canada Inc.
 PO Box 240, 36 Wolfe St.
 Frankford, Ontario K0K 2C0